

## GETTING STARTED WITH YOUR NEW XP5s



DOWNLOAD THE USER GUIDE AT [WWW.SONIMTECH.COM](http://WWW.SONIMTECH.COM)

**sonim**  
BUILT FOR LIFE™

1. Sonim XPand Connector
2. Microphones
3. USB-C
4. Volume Up / Down
5. PTT Button
6. App Tray
7. Options
8. Clear
9. Answer / Accept
10. Voicemail (Press and Hold)
11. Lock Keypad (Press and Hold)
12. Select
13. Navigation
14. End / Reject / Power On & Off (Press and Hold)
15. Speakerphone
16. Back
17. Display
18. Battery Level Indicator
19. Notification Bar
20. Receiver
21. LED Notification
22. Sonim Secure Audio Connector
23. Emergency Button
24. Charging Pins
25. Battery Under Door
26. SIM Card Slots Under Battery
27. Memory Card Slot Under Battery
28. Battery Door
29. Rear Flash
30. Rear Facing Camera

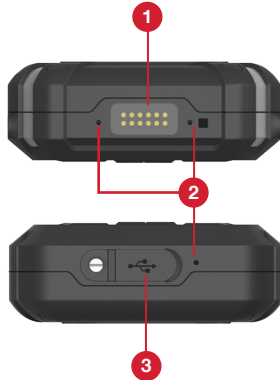

### INBOX COMPONENTS

Sonim XP5s  
Battery  
Wall Charger  
USB-C Cable  
Screwdriver  
Quick Start Guide



## SONIM XP5s QUICK START GUIDE

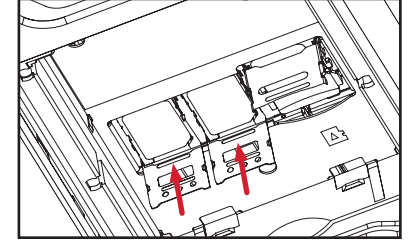

### HOW TO INSERT THE SIM CARD

**Step 1** Use the included screwdriver to unscrew the two battery door screws on the back of the phone.

**Step 2** Remove battery door and battery.

**Step 3** Open either SIM card tray, insert SIM card and lock SIM card tray into place.

### INITIAL PHONE SET-UP

Ensure that a valid SIM card is inserted in your phone. Press and hold Power On / Off key to turn power On. After the phone successfully registers with the network, the name of the service provider is displayed in the Navigation Bar. When powering the phone On for the first time, a Welcome Screen is displayed. To set up the phone, select Start and follow the instructions shown on the phone screen. After the initial phone set-up is complete, the Home Screen is displayed.

### MAKE A CALL

From Home Screen, dial number and select Answer / Accept

### SET-UP WIFI

From Home Screen, select:  
Menu > Settings > Wireless & Networks > WLAN > On > choose network > enter password > Connect

### USING YOUR SONIM SECURE AUDIO CONNECTOR

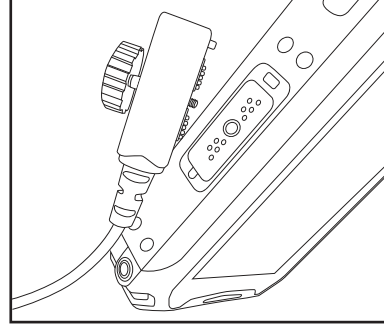

Provides a secure-connection and power for ultra-reliable, ultra-loud and ultra-clear mission critical audio products. Visit [www.sonimtech.com](http://www.sonimtech.com) for a broad portfolio of Sonim certified accessories, including remote speaker microphones, headsets, 3.5mm adapter, holsters, multi-bay chargers, vehicle kits, and more. Accessories sold separately.

### SONIM SCOUT

Take full advantage of your Sonim XP5s by utilizing the SCOUT assistant on your phone and registering your company on Sonim Cloud [www.sonimcloud.com](http://www.sonimcloud.com).



### BATTERY

The battery in your phone is not fully charged. We recommend that you charge the phone for 2.5 hours.

### 3 YEARS WARRANTY

Sonim Technologies provides a 3-Year comprehensive warranty on the phone, and a 1-Year warranty on the battery. For more information related to the warranty, please contact your service provider.

### SUPPORT

Email: [SolInCustomerSupport@southernco.com](mailto:SolInCustomerSupport@southernco.com)  
Phone: 1-800-406-0151